

TWO-TOUCH FITTING

Application

- Nut-tightened air connector used for pneumatic piping.

Feature

- Effective use at the place of vibration or rocking.
- Long life-span made of plastic.
- Excellent in anti-corrosion and anti-chemicals.

Specification

Fluid	Air (No other gases or liquids)	
Working Pressure Range	0~150PSI	0~9(Kgf/cm ²) (0~900KPa)
Negative Pressure	-29.50 in Hg	-750mmHg (10Torr)
Temperature Range	32~140° F	0~60° C
Applicable Tube Material	Polyurethane and Nylon	

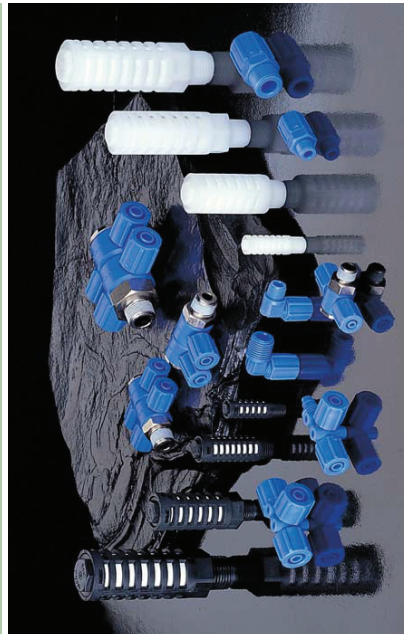

Product Code System

TC 04 - 01

① Type ② ③

Code	Type	Metric Size			
		TC	TL	TUT	THL
	STRAIGHT	ELBOW	UNION	TEE	THL ELBOW ROTATION

(2) Tube Dia (øD)

Code	Dia	04	06	08	10	12
		ø4.2x2.5	ø5.0x2.4	ø5.5x2.5	ø7.0x2.5	ø7.2x2.8

(3) Thread Size(T)

Code	Thread Size	01	02	03	04
		R1/8	R1/4	R3/8	R1/2

Structural Diagram

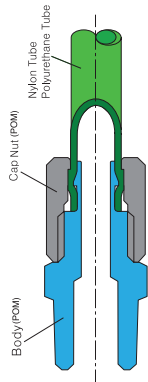

Two -Touch Fitting



CAUTION

- Be sure to read the "Common Precautions" and "Using Precautions of Fitting Series" (P6) before using.
- Fastening the cap by force will cause damage on thread or body.
- Push the tube fully into the end when connecting.
- Cut the used part of tube after using once.
- Seal with rethon, failure to do so will cause air leakage.

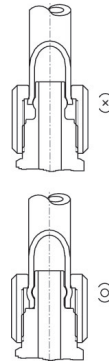

TC

Straight



MODEL [ØD-T]

MODEL	ØD	R
TC 04-01	4	R1/8
TC 04-02	4	R1/4
TC 06-01	6	R1/8
TC 06-02	6	R1/4
TC 08-01	8	R1/8
TC 08-02	8	R1/4
TC 08-03	8	R3/8
TC 10-02	10	R1/4
TC 10-03	10	R3/8
TC 12-03	12	R3/8
TC 12-04	12	R1/2

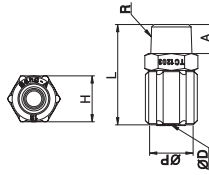

TL

Elbow



MODEL [ØD-T]

MODEL	ØD	R
TL 04-01	4	R1/8
TL 04-02	4	R1/4
TL 06-01	6	R1/8
TL 06-02	6	R1/4
TL 08-01	8	R1/8
TL 08-02	8	R1/4
TL 08-03	8	R3/8
TL 10-02	10	R1/4
TL 10-03	10	R3/8
TL 12-03	12	R3/8
TL 12-04	12	R1/2

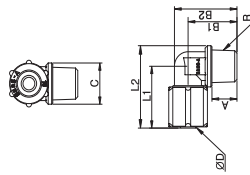

TUT

Union Tee



MODEL [ØD-T]

MODEL	ØD	R
TUT 04	4	
TUT 06	6	
TUT 08	8	
TUT 10	10	
TUT 12	12	

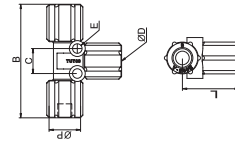

THT (D1)

Single Universal Tee



MODEL [ØD-T]

MODEL	ØD	R
THT 0401-D1	4	R1/8
THT 0402-D1	4	R1/4
THT 0601-D1	6	R1/8
THT 0602-D1	6	R1/4
THT 0801-D1	8	R1/8
THT 0802-D1	8	R1/4
THT 0803-D1	8	R3/8
THT 1002-D1	10	R1/4
THT 1003-D1	10	R3/8
THT 1004-D1	10	R1/2
THT 1202-D1	12	R1/4
THT 1203-D1	12	R3/8
THT 1204-D1	12	R1/2

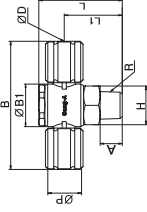

THT (D2)

Double Universal Tee



MODEL [ØD-T]

MODEL	ØD	R
THT 0401-D2	4	R1/8
THT 0402-D2	4	R1/4
THT 0601-D2	6	R1/8
THT 0602-D2	6	R1/4
THT 0801-D2	8	R1/8
THT 0802-D2	8	R1/4
THT 0803-D2	8	R3/8
THT 1002-D2	10	R1/4
THT 1003-D2	10	R3/8
THT 1004-D2	10	R1/2
THT 1202-D2	12	R1/4
THT 1203-D2	12	R3/8
THT 1204-D2	12	R1/2

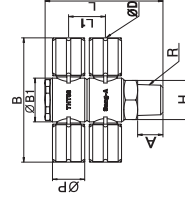

THT (D3)

Triple Universal Tee



MODEL [ØD-T]

MODEL	ØD	R
THT 0401-D3	4	R1/8
THT 0402-D3	4	R1/4
THT 0601-D3	6	R1/8
THT 0602-D3	6	R1/4
THT 0801-D3	8	R1/8
THT 0802-D3	8	R1/4
THT 0803-D3	8	R3/8
THT 1002-D3	10	R1/4
THT 1003-D3	10	R3/8
THT 1004-D3	10	R1/2
THT 1202-D3	12	R1/4
THT 1203-D3	12	R3/8
THT 1204-D3	12	R1/2

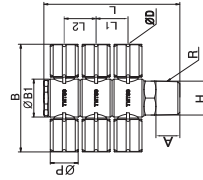

THL (D1)
Single Universal Elbow



MODEL [ØD-T]

MODEL	Tube (Metric)	Thread (R)	ØD	R
THL 0401-D1	4	R1/8		
THL 0402-D1	4	R1/4		
THL 0601-D1	6	R1/8		
THL 0602-D1	6	R1/4		
THL 0801-D1	8	R1/8		
THL 0802-D1	8	R1/4		
THL 0803-D1	8	R3/8		
THL 1002-D1	10	R1/4		
THL 1003-D1	10	R3/8		
THL 1004-D1	10	R1/2		
THL 1202-D1	12	R1/4		
THL 1203-D1	12	R3/8		
THL 1204-D1	12	R1/2		

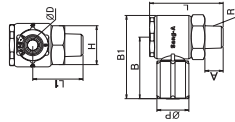

THL (D2)
Double Universal Elbow



MODEL [ØD-T]

MODEL	Tube (Metric)	Thread (R)	ØD	R
THL 0401-D2	4	R1/8		
THL 0402-D2	4	R1/4		
THL 0601-D2	6	R1/8		
THL 0602-D2	6	R1/4		
THL 0801-D2	8	R1/8		
THL 0802-D2	8	R1/4		
THL 0803-D2	8	R3/8		
THL 1002-D2	10	R1/4		
THL 1003-D2	10	R3/8		
THL 1004-D2	10	R1/2		
THL 1202-D2	12	R1/4		
THL 1203-D2	12	R3/8		
THL 1204-D2	12	R1/2		

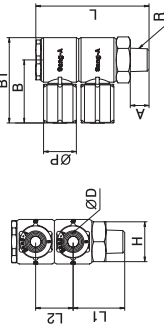

THL (D3)
Triple Universal Elbow



MODEL [ØD-T]

MODEL	Tube (Metric)	Thread (R)	ØD	R
THL 0401-D3	4	R1/8		
THL 0402-D3	4	R1/4		
THL 0601-D3	6	R1/8		
THL 0602-D3	6	R1/4		
THL 0801-D3	8	R1/8		
THL 0802-D3	8	R1/4		
THL 0803-D3	8	R3/8		
THL 1002-D3	10	R1/4		
THL 1003-D3	10	R3/8		
THL 1004-D3	10	R1/2		
THL 1202-D3	12	R1/4		
THL 1203-D3	12	R3/8		
THL 1204-D3	12	R1/2		

